

2040 SQ.FT. (STD PLAN "CONDITIONED")
 N/A SQ.FT. (W/OPT. PORCH/RECESS "CONDITIONED")

CMH MANUFACTURING Product Designer: JDC	Model #: SLT32685A Date: 8/11/15	Drawing #: Scale: NTS 38M145
	32 X 68 SOLUTION	
ELEVATION		

20 lb ROOF LOAD SIDEWALL OPENING PIER LOAD 32' BOX WIDTH	SIDEWALL OPENING (FT) REQUIRED PIER LOAD (LBS)					
	3	4	5	6	8	10
	1244	1413	1581	1750	2088	2425

*FOR 30 lb & 40 lb ROOF LOAD REFER TO TABLES 7b & 7c IN THE INSTALLATION MANUAL.

20 psf Roof Live Load		
Column Pier #	Distance from Hitch	Pier Load (lbs)
1	11.25	1525
2	16.25	1525
3	27.417	4609
4	46.125	4609

30 psf Roof Live Load		
Column Pier #	Distance from Hitch	Pier Load (lbs)
1	11.25	3100
2	16.25	3100
3	27.417	7212
4	46.125	7212

40 psf Roof Live Load		
Column Pier #	Distance from Hitch	Pier Load (lbs)
1	11.25	3775
2	16.25	3775
3	27.417	8916
4	46.125	8916

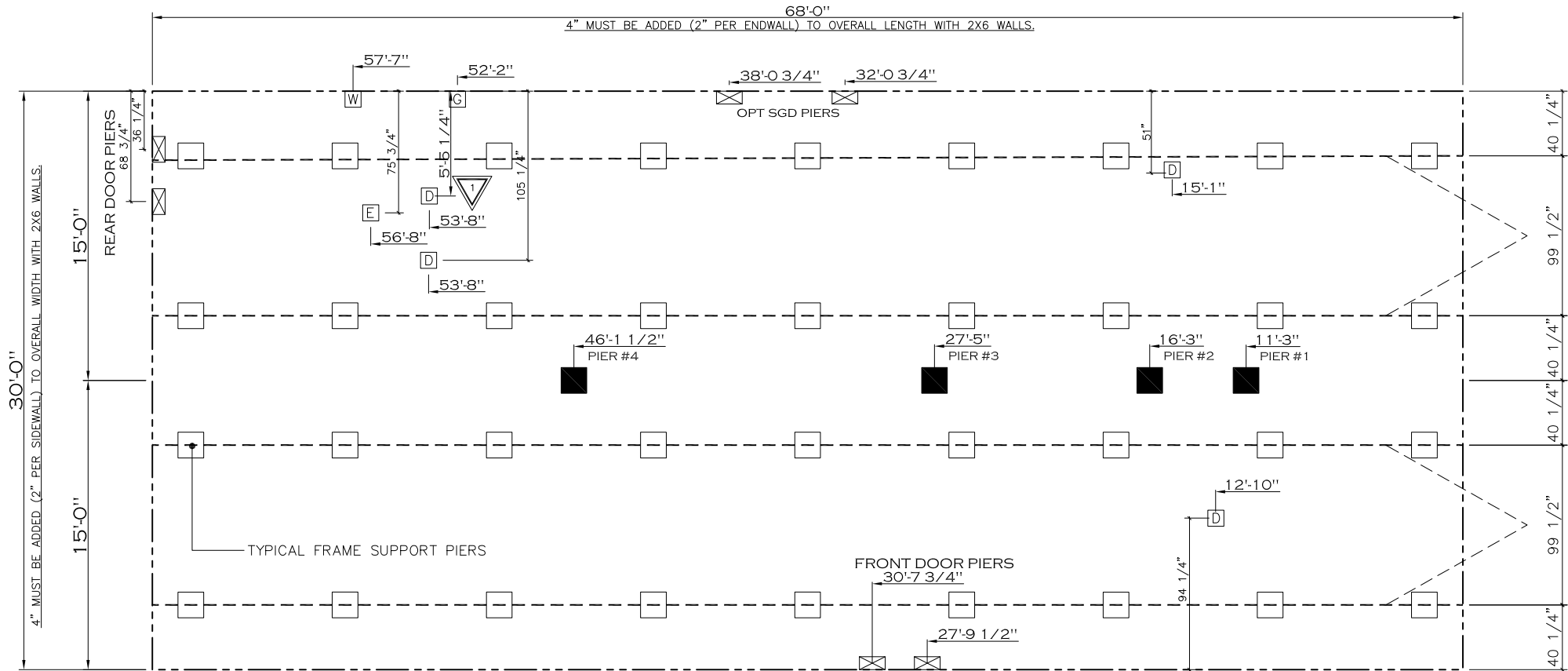

GENERAL NOTES:

- PIER LOADS SHOWN ARE TO BE USED TO SIZE THE FOOTINGS BELOW THE MARRIAGEWALL FOR COLUMN SUPPORT PIERS. REFER TO TABLES 6b AND 6c IN THE INSTALLATION MANUAL FOR LOAD ON FRAME PIER FOOTINGS FOR HOMES THAT DO NOT REQUIRE PERIMETER BLOCKING. REFER TO TABLES 7b AND 7c IN THE INSTALLATION MANUAL FOR LOAD ON FRAME PIER FOOTINGS THAT REQUIRE PERIMETER BLOCKING. REFER TO TABLES 10 AND 10a TO DETERMINE FOOTING SIZE FOR ALL PIERS.
- REFER TO TABLE 9 FOR PIER CONFIGURATION AND MAXIMUM ALLOWABLE HEIGHTS. CROSS REFERENCE THE PIER HEIGHT WITH THE MAXIMUM ALLOWABLE FLOOR HEIGHT LISTED IN THE FRAME TIEDOWN CHARTS (TABLE 18, 19, AND 20).
- FLOOR WIDTH SHOWN IS FOR STANDARD PRODUCT ONLY. CONTACT THE MFG PLANT FOR SPECIFICATIONS OF OPTIONS ORDERED.
- SERVICE DROP LOCATIONS IDENTIFIED ARE APPROXIMATE.
- THE MAXIMUM SPACING FOR 8" I-BEAMS IS 8 FEET, 10" & 12" I-BEAMS ARE 10 FEET.

PIER LEGEND	
□	= SUPPORT UNDER MATING OPENING
■	= SUPPORT AT MATING COLUMN
▣	= SUPPORT UNDER MATING WALL
◼	= PIER PORCH/RECESSED ENTRY
□	= PIER MAIN BEAM
⊠	= PIER PERIMETER

SERVICE DROP LEGEND	
E	= ELECTRICAL DROP
W	= WATER INLET
D	= DWV PLUMBING DROP
G	= GAS INLET

2040 SQ.FT. (STD PLAN "CONDITIONED")
N/A SQ.FT. (W/OPT. PORCH/RECESS "CONDITIONED")

CMH MANUFACTURING Product Designer: JDC	Model #: SLT32685A	Drawing #:
	Date: 8/11/15	Scale: NTS
32 X 68 SOLUTION		
PIER LOADS		REVISION ECR- 1/15/16 JDC

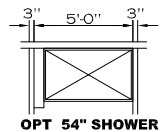
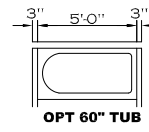
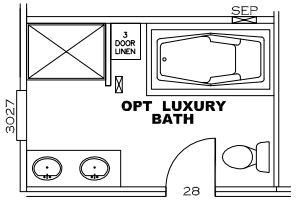
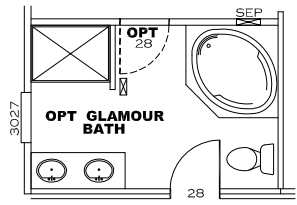

OPT S.G.D.

OPT TRANSOM
3612
60" A.F.F.

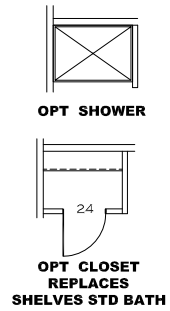
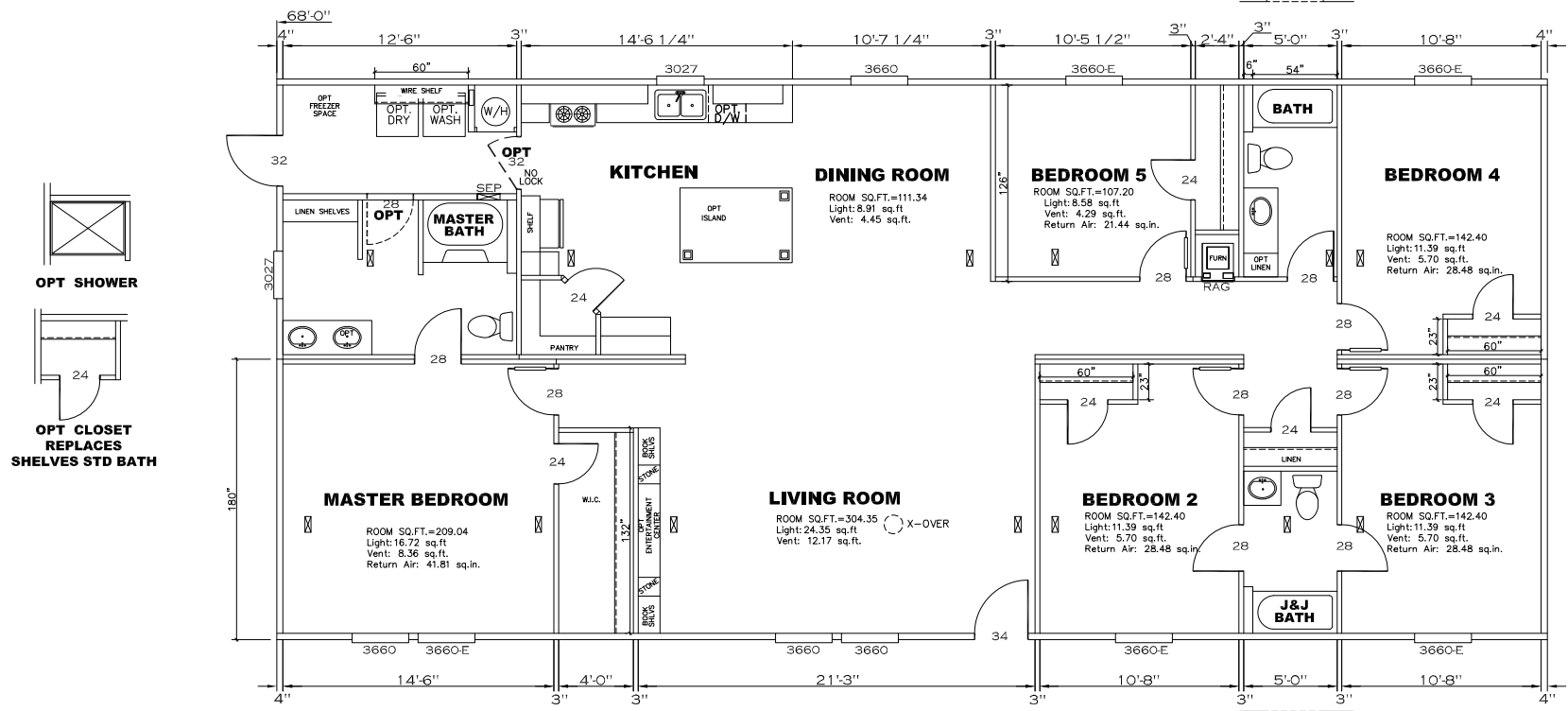

APPROVED **HWC** **APPROVED**
 REVISED
 SEPT 30 2015
 Federal Manufactured
 Home Construction
 And Safety Standards

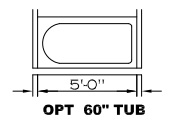
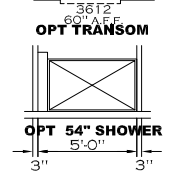

FP-32-2027

2040 SQ.FT. (STD PLAN "CONDITIONED")		N/A SQ.FT. (W/OPT. PORCH/RECESS "CONDITIONED")	
CMH MANUFACTURING	Model #: SLT32685A	Drawing #:	
Product Designer: JDC	Date: 8/11/15	Scale: NTS	38M145
32 X 68 SOLUTION			
FLOOR PLAN		REVISION ECR-228406 8/22/15 JDC	

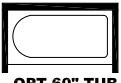

OPT 60" TUB

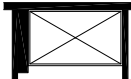

OPT 54" SHOWER

OPT TRANSOM

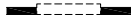

OPT S.G.D.



OPT CLOSET REPLACES SHELVES STD BATH

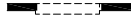

OPT TRANSOM

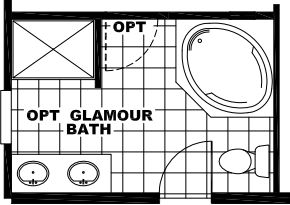

OPT GLAMOUR BATH

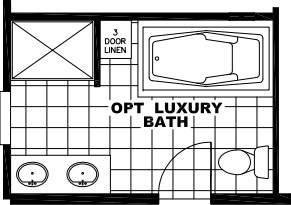

OPT LUXURY BATH



OPT LINO ENTRY

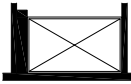

OPT 54" SHOWER

OPT 60" TUB

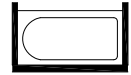

2040 SQ.FT.
Model #: SLT32685A
SOLUTION
Drawing #:
38M145

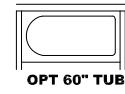
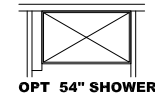
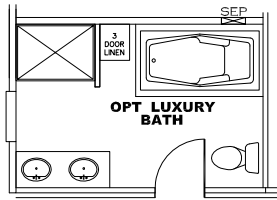
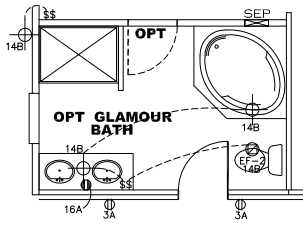

OPT TRANSOM

OPT TRANSOM



OPT SHOWER



OPT CLOSET REPLACES SHELVES STD BATH

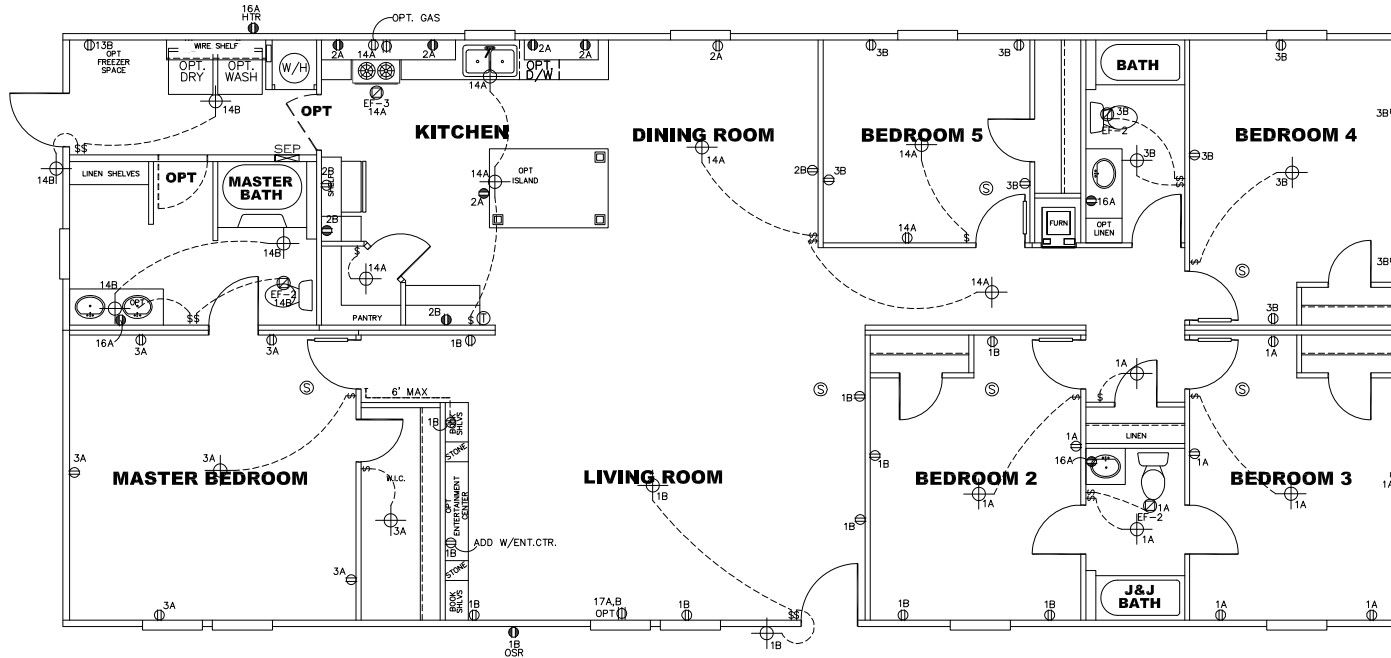

NOTES:

1. ALL CIRCUITS SHOWN ARE FOR REFERENCE AND MAY BE CHANGED BASED ON OPTIONAL COMPONENTS INSTALLED IN THE HOME.
2. REFER TO EL SECTION OF THE DAPIA FOR SYMBOL CHART.
3. EITHER LIGHT OR RECEPTACLE MUST CONNECT TO SWITCH.
4. EF-1= 50 CFM EXHAUST FAN REQUIRED FOR THERMAL ZONE III THERMAL ZONES I & II MAY USE FAN OR WINDOW W/1.5 SQ. FT. OPENABLE GLASS.
5. EF-2= 50 CFM EXHAUST FAN REQUIRED THERMAL ZONE I, II, AND III.
6. EF-3= 100 CFM RANGE EXHAUST FAN, SWITCH AT HOOD.
7. EF-4= WHOLE HOUSE VENTILATION PER REQUIREMENTS IN S-HV-10 & 10A OR M-HV-11 & 11A OF DAPIA.
8. REFER TO EL SECTION OF THE DAPIA OR THE MFG. INSTALLATION INSTRUCTIONS FOR PROPER WIRE SIZE AND BREAKER SIZE FOR SPECIFIC APPLIANCE AND MODEL BEING INSTALLED.
9. ALL SMOKE ALARMS TO BE LOCATED ON THE CEILING.
10. DIMENSIONS SHOWN ON PRINT ARE APPROXIMATE AND TO BE USED ONLY AS A GUIDELINE.

APPROVED **BWG** **APPROVED**
 Revised
 SEPT 30 2015
 Federal Manufactured
 Home Construction
 And Safety Standards



OPT TRANSOM

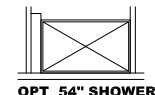

OPT 54" SHOWER

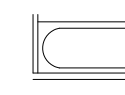

OPT 60" TUB

CIRCUIT	CIRCUIT #	WIRE	BREAKER	CIRCUIT	CIRCUIT #	WIRE	BREAKER	CIRCUIT	CIRCUIT #	WIRE	BREAKER
LIGHT/RECP	1A,1B,3A,3B,14A,14B	14-2	15-SP	WATER HEATER	4A,6B	SEE NOTE #8		BATH/HTR	16A	12-2	20-SP
KIT/DINING	2A,2B	12-2	20-SP	RANGE	5B,7A	SEE NOTE #8		OPT G/DISP	9B	SEE NOTE #8	
WASHER	12A	12-2	20-SP	FURNACE	6A,8A,B,10A,B	SEE NOTE #8		OPT SPA/W2/JAC	11A,B	SEE NOTE #8	
DRYER	5A,7B	SEE NOTE #8		OPT D/WASH	9A	SEE NOTE #8		FREEZER	13B	SEE NOTE #8	
				SMOKE ALARM	4B	SEE NOTE #8		OPT/AC UNIT	17A,B	SEE NOTE #8	

FP-32-2027

2040 SQ.FT. (STD PLAN "CONDITIONED")
N/A SQ.FT. (W/OPT. PORCH/RECESS "CONDITIONED")

CMH MANUFACTURING	Model #: SLT32685A	Drawing #:
	Date: 8/11/15	Scale: NTS 38M145
Product Designer: JDC	32 X 68 SOLUTION	
ELECTRICAL PLAN-06		
REVISION ECR-228406 8/22/15 JDC		

**SUPPLY
OPT. GLAMOUR &
LUXURY BATHS**

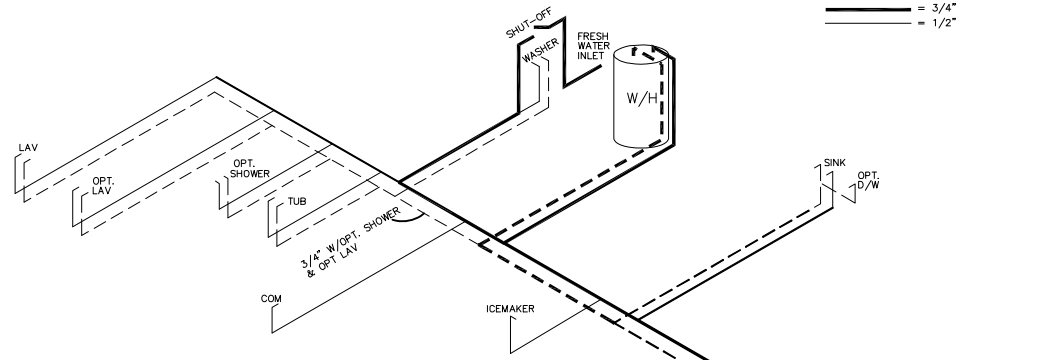
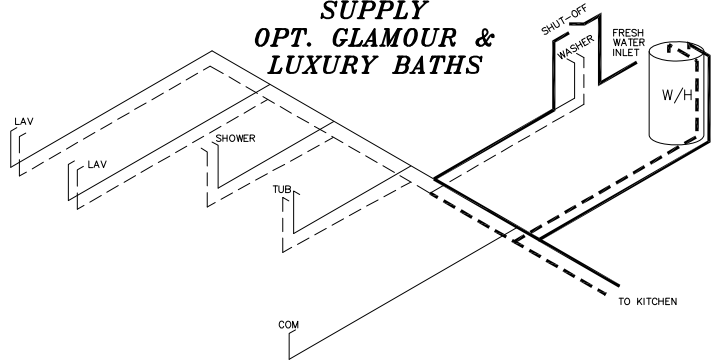

NOTE:
DASHED LINES INDICATES HOT WATER
SOLID LINES INDICATES COLD WATER
—— = 3/4"
—— = 1/2"

Supply Lines

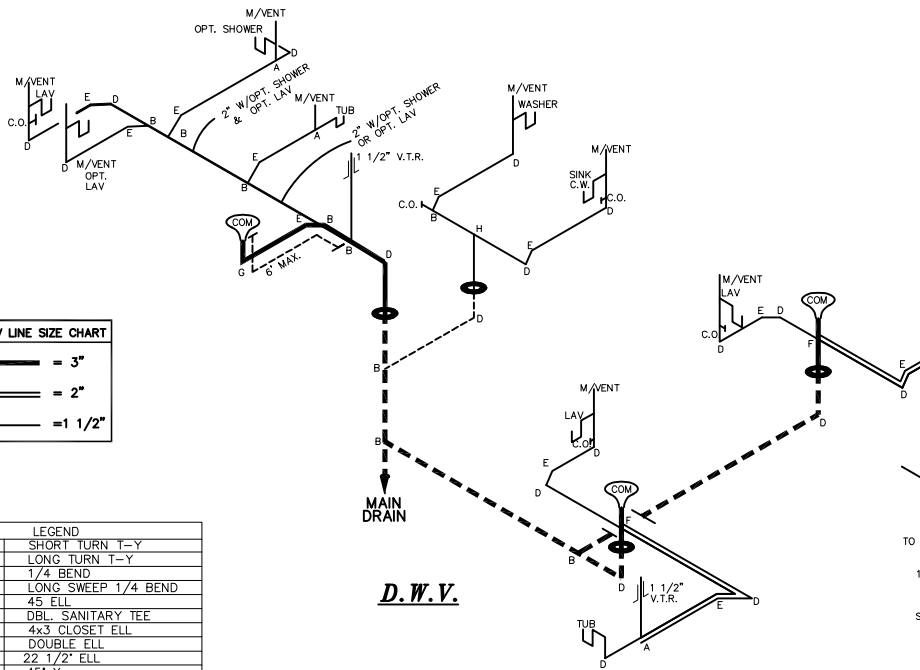
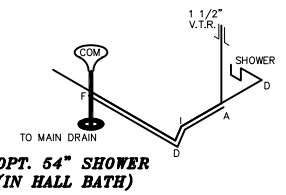
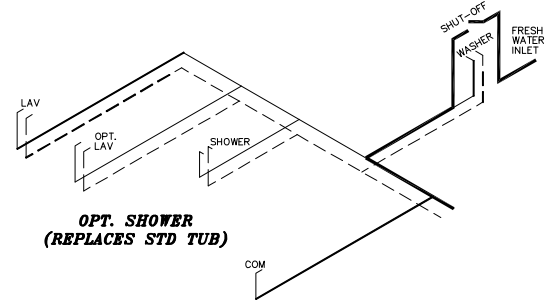
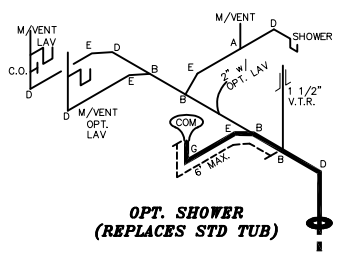

DWV LINE SIZE CHART

——	= 3"
——	= 2"
——	= 1 1/2"

LEGEND

A	SHORT TURN T-Y
B	LONG TURN T-Y
C	1/4 BEND
D	LONG SWEEP 1/4 BEND
E	45 ELL
F	DBL. SANITARY TEE
G	4x3 CLOSET ELL
H	DOUBLE ELL
I	22 1/2" ELL
J	45° Y
K	LONG TURN STREET ELBOW
L	45 FTG ELL

APPROVED
REVISED
15 JUN 2016
FP-32-2027
Federal Manufactured
Home Construction
And Safety Standards
APPROVED

**D.W.V.
OPT. GLAMOUR &
LUXURY BATHS**

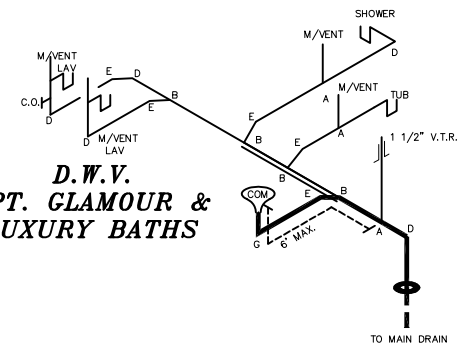

D.W.V.

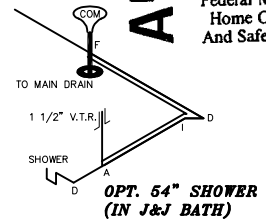

2040 SQ.FT. (STD PLAN "CONDITIONED")
N/A SQ.FT. (W/OPT. PORCH/RECESS "CONDITIONED")

CMH MANUFACTURING	Model #: SLT32685A	Drawing #:
	Date: 8/11/15	Scale: NTS 38M145
Product Designer: JDC	32 X 68 SOLUTION	
D.W.V. and Supply Lines		3/REVISION ECR-315310 4/12/16 JDC